

2005-08 ACCESSORIES AND EQUIPMENT

Exterior Trim - RL

HOOD MOLDING REPLACEMENT

Special Tools Required

KTC trim tool set SOJATP2014 *

* Available through the American Honda Tool and Equipment Program; call 888-424-6857

NOTE:

- Use the appropriate tool from the KTC trim tool set to avoid damage when prying components.
- Take care not to scratch the hood.

1. Using a 6 mm socket wrench, remove the special nuts (A), and detach the clip (B) by pushing it, then remove the hood molding (C). Take care not to scratch the hood.

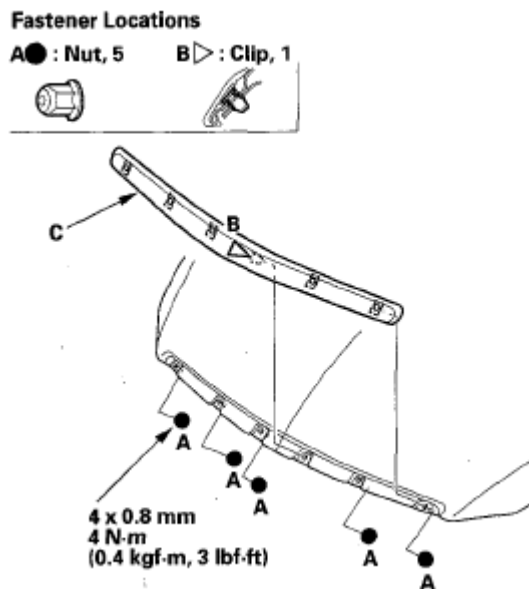

Fig. 1: Identifying Hood Molding With Torque Specifications
Courtesy of AMERICAN HONDA MOTOR CO., INC.

2. Install the molding in the reverse order of removal.

NOTE:

Check if the clip is damaged or stress-whitened, and if necessary, replace it with a new one.

UPPER GRILLE REPLACEMENT

Special Tools Required

KTC trim tool set SOJATP2014 *

* Available through the American Honda Tool and Equipment Program; call 888-424-6857

NOTE:

- Use the appropriate tool from the KTC trim tool set to avoid damage when prying components.
- Take care not to scratch the bumper and grille.

1. Remove the upper grille cover (see **UPPER GRILLE COVER REPLACEMENT**).
2. Pull out the upper grille (A) and detach the clips, then remove the upper grille. Take care not to drop the clips inside the front bumper (B).

Fastener Locations

▷ : Clip, 2

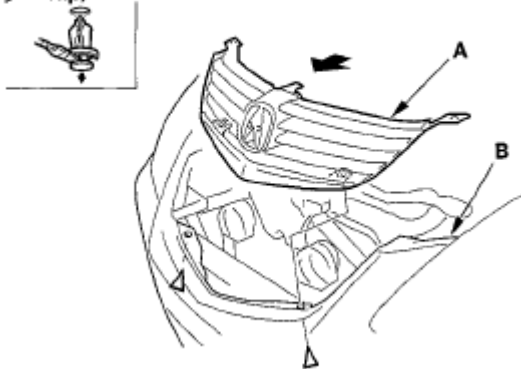

Fig. 2: Identifying Upper Grille And Front Bumper
Courtesy of AMERICAN HONDA MOTOR CO., INC.

3. If necessary, remove the screws, then remove the emblem base (A) and upper grille molding (B) from the upper grille.

Fastener Locations

▶ : Screw, 7

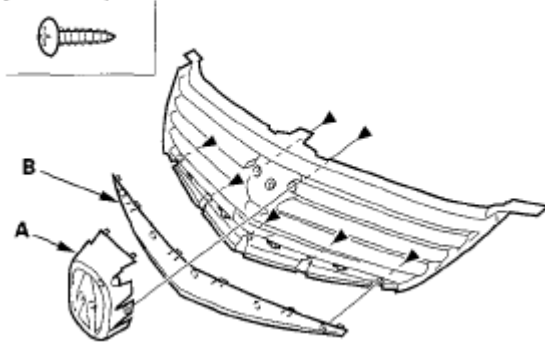

Fig. 3: Identifying Emblem Base, Upper Grille Molding And Upper Grille
Courtesy of AMERICAN HONDA MOTOR CO., INC.

4. Install the grille in the reverse order of removal.

UPPER FENDER TRIM REPLACEMENT

Special Tools Required

KTC trim tool set SOJATP2014 *

* Available through the American Honda Tool and Equipment Program; call 888-424-6857

NOTE:

- Use the appropriate tool from the KTC trim tool set to avoid damage when prying components.
- Take care not to scratch the grille and body.

1. Disconnect the washer reservoir tubes (A). Detach the clips and release the pin (B), then remove the right upper fender trim (C).

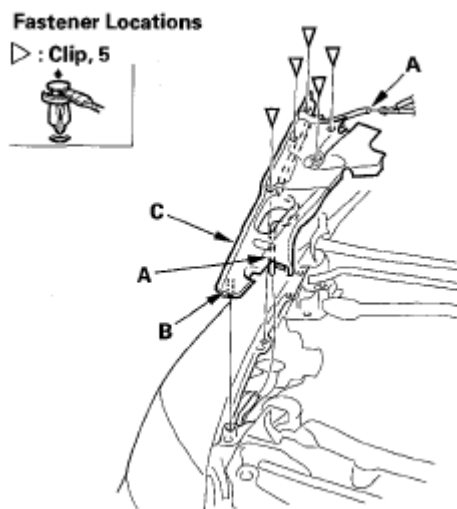

Fig. 4: Identifying Right Upper Fender Trim, Washer Reservoir Tubes And Pin
Courtesy of AMERICAN HONDA MOTOR CO., INC.

2. Release the hooks (A, B), then remove the battery trim (C) from the upper fender trim (D) and grille cover (E).

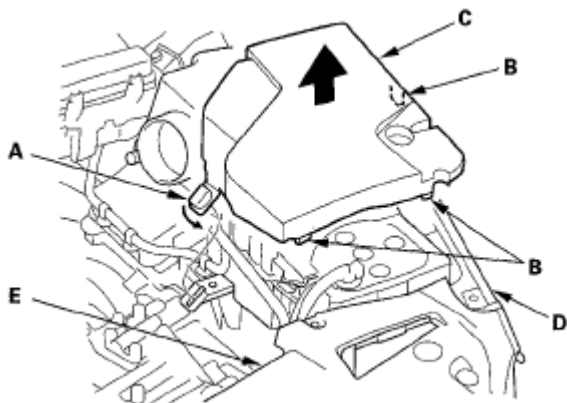

Fig. 5: Identifying Battery Trim, Upper Fender Trim And Grille Cover
Courtesy of AMERICAN HONDA MOTOR CO., INC.

3. Detach the clips, and release the pin (A), then remove the left upper fender trim (B).

Fastener Locations

▷ : Clip, 5

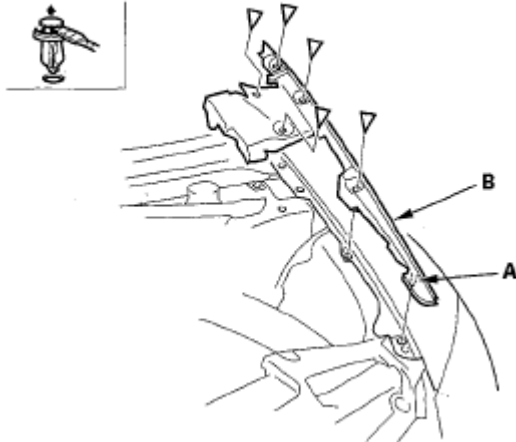

Fig. 6: Identifying Left Upper Fender Trim And Clips
Courtesy of AMERICAN HONDA MOTOR CO., INC.

4. Install the upper fender trim in the reverse order of removal, and note these items:
 - Check if the clips are damaged or stress-whitened, and if necessary, replace them with new ones.
 - Push the clips into place securely.
 - Make sure the windshield washer tubes are connected properly.

UPPER GRILLE COVER REPLACEMENT

Special Tools Required

- KTC trim tool set SOJATP2014 *
- Push pin puller 07AAC-SJAA100

* Available through the American Honda Tool and Equipment Program; call 888-424-6857

NOTE:

- Use the appropriate tool from the KTC trim tool set to avoid damage when prying components.
- Take care not to scratch the front bulkhead and body.

1. Pull up the front portion of the upper fender trim, from each side (see **UPPER FENDER TRIM REPLACEMENT**).
2. Detach the clips (A, B). Using a trim tool, detach the hooks (C) and clip (D), then remove the upper grille cover (E).

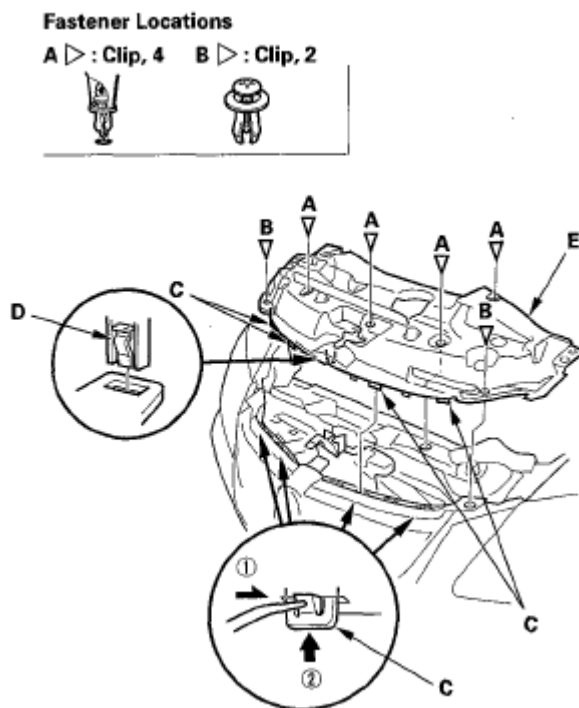

Fig. 7: Identifying Upper Grille Cover, Clips And Hooks
 Courtesy of AMERICAN HONDA MOTOR CO., INC.

3. Install the upper grille cover in the reverse order of removal, and note these items:
 - Check if the clips are damaged or stress-whitened, and if necessary, replace them with new ones.
 - Push the clips into place securely.

COWL COVER REPLACEMENT

NOTE:

- Take care not to scratch the cowl cover and body.
- Use a clip remover to remove the hood rear seal clips.

1. Detach the clips (A, B, C), then remove the cowl cover upper trim (D).

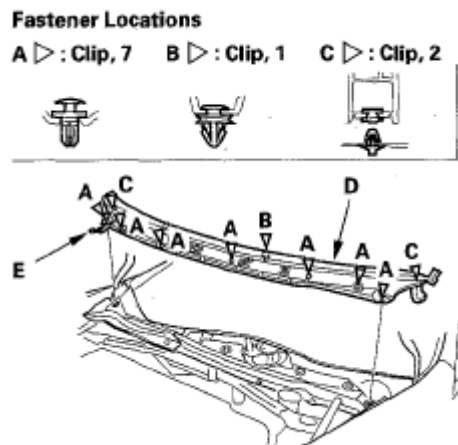

Fig. 8: Identifying Cowl Cover Upper Trim And Clips
 Courtesy of AMERICAN HONDA MOTOR CO., INC.

2. Disconnect the windshield washer tubes (E).
3. Remove the windshield wiper arms (see **WIPER MOTOR REPLACEMENT**).
4. Remove the rear hood seal (A) then, detach the clips (B, C, D) by carefully pulling the passenger's cowl cover (E) upward, and release the hook (F) on the passenger's cowl cover from the driver's cowl cover (G), then remove the cover by releasing the hooks (H).

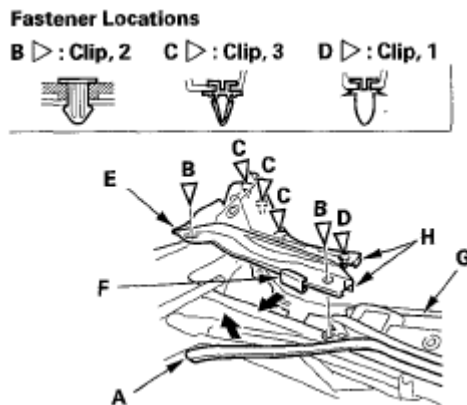

Fig. 9: Identifying Rear Hood Seal, Clips And Passenger's Cowl Cover
 Courtesy of AMERICAN HONDA MOTOR CO., INC.

5. Remove the rear hood seal (A), then detach the clips (B, C, D) by carefully pulling the driver's cowl cover (E) upward, then remove the cover by releasing the hooks (F).

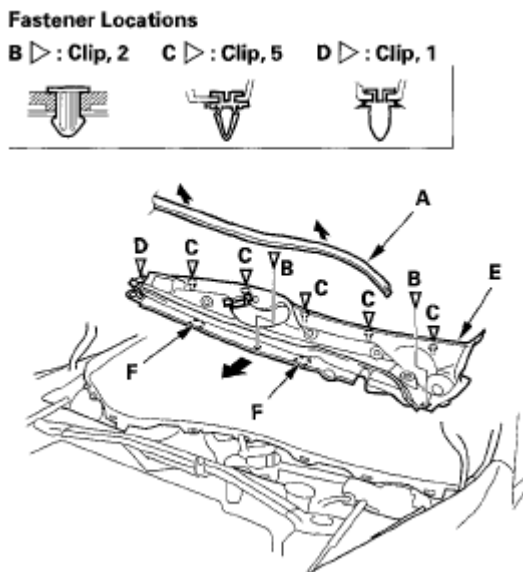

Fig. 10: Identifying Driver's Cowl Cover, Rear Hood Seal And Hooks
 Courtesy of AMERICAN HONDA MOTOR CO., INC.

6. Install the covers in the reverse order of removal, and note these items:
 - Check if the clips are damaged or stress-whitened, and if necessary, replace them with new ones.

- Make sure the washer tubes are connected securely.
- Push the clips into place securely.

WINDSHIELD SIDE TRIM REPLACEMENT

Special Tools Required

KTC trim tool set SOJATP2014 *

* Available through the American Honda Tool and Equipment Program; call 888-424-6857

NOTE:

- Put on gloves to protect your hands.
- Take care not to damage the windshield.
- Do not use any metal tools to remove the windshield side trim, or you may chip the edge of the windshield and some cracks in the windshield will result.
- Use the appropriate tool from the KTC trim tool set to avoid damage when prying components.
- Take care not to bend the windshield side trim.

TRIM REPLACEMENT

1. Remove the cowl cover upper trim (see **COWL COVER REPLACEMENT**).
2. Remove the windshield side trim (A).
 1. Carefully insert a trim tool (B) under the trim next to the lower clip (C).
 2. While pushing the clip portion of the trim to the pillar side by hand, gently pry up the trim to release the trim from the retainers (D).
 3. Gradually work your way up to release each of the upper clips (E, F, G).

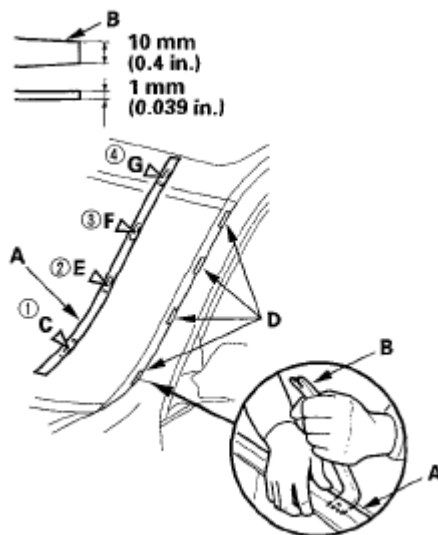

Fig. 11: Identifying Lower Clip, Windshield Side Trim And Clips
Courtesy of AMERICAN HONDA MOTOR CO., INC.

3. Install the trim in the reverse order of removal, and note these items:
 - Make sure the trim is installed securely.
 - Replace any damaged retainer.

RETAINER REPLACEMENT

1. Gradually separate the adhesive tape (A) under the retainers (B) while heating them with a heat gun to about 212-248°F (100-120°C).

NOTE:

- Do not overheat the painted surface around the retainers.
- To keep the exterior resin parts near the A-pillar from being overheated by the heat gun, wrap them with an aluminum foil.

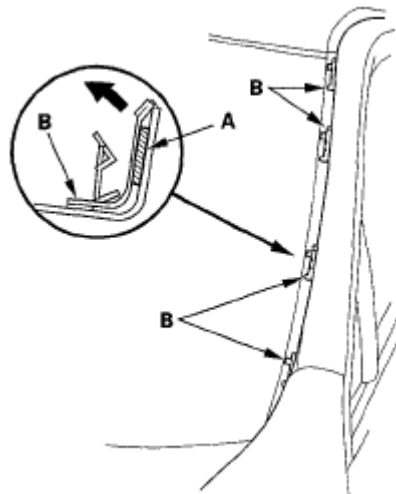

Fig. 12: Identifying Retainer
Courtesy of AMERICAN HONDA MOTOR CO., INC.

2. Clean the body bonding surface with a sponge dampened in alcohol. After cleaning, keep oil, grease, and water from getting on the surface.
3. Install the retainers (A).
 1. Peel the adhesive backing away from the retainers.
 2. Line up the retainers with the alignment marks (B) on the body, and attach them with adhesive tape (C).
 3. Apply epoxy two-part adhesive (D) around the edge of the retainers as shown.

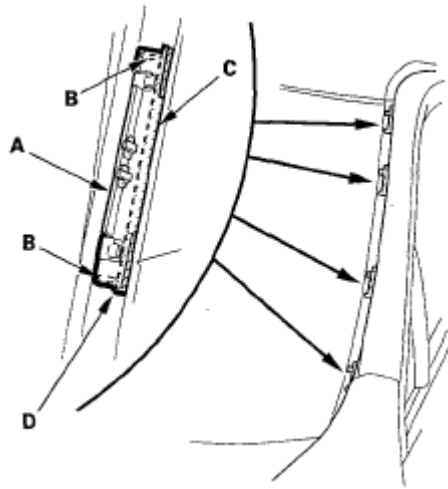

Fig. 13: Identifying Retainer And Adhesive Tape
Courtesy of AMERICAN HONDA MOTOR CO., INC.

ROOF MOLDING REPLACEMENT

Special Tools Required

KTC trim tool set SOJATP2014 *

* Available through the American Honda Tool and Equipment Program; call 888-424-6857

NOTE:

- Use the appropriate tool from the KTC trim tool set to avoid damage when prying components.
- Take care not to scratch the body.

1. Apply protective tape (A) to the body. Using a trim tool, pry up on the roof molding (B).

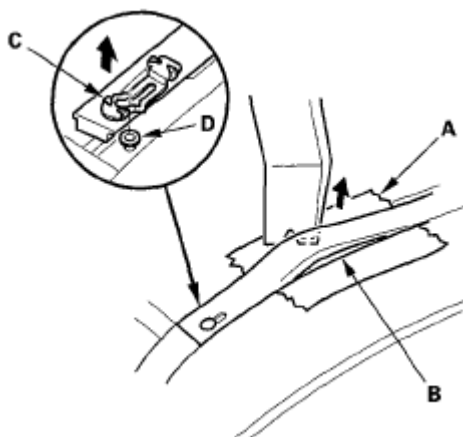

Fig. 14: Applying Protective Tape To Body
Courtesy of AMERICAN HONDA MOTOR CO., INC.

2. Pull up and slide the roof molding to release the front bracket (C) from the pin (D).

3. Pull up the front portion of the roof molding (A).

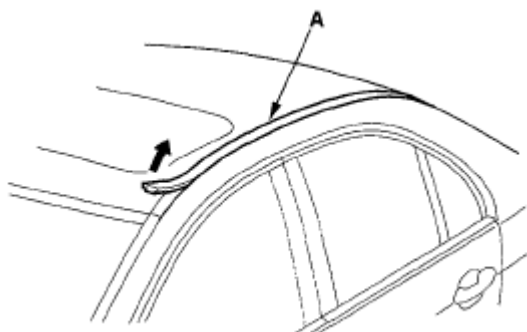

Fig. 15: Pulling Front Portion Of Roof Molding
Courtesy of AMERICAN HONDA MOTOR CO., INC.

4. Pull up and release the rear bracket (A) from the pin (B), then remove the roof molding (C).

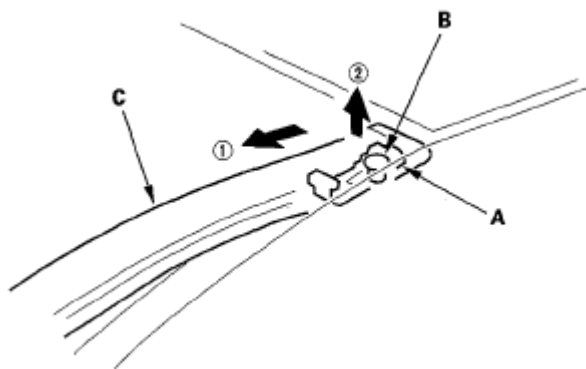

Fig. 16: Releasing Rear Bracket, Pin And Roof Molding
Courtesy of AMERICAN HONDA MOTOR CO., INC.

5. Install the molding in the reverse order of removal, and note these items:
 - Take care not to damage the windshield molding.
 - Make sure the roof molding is installed securely.

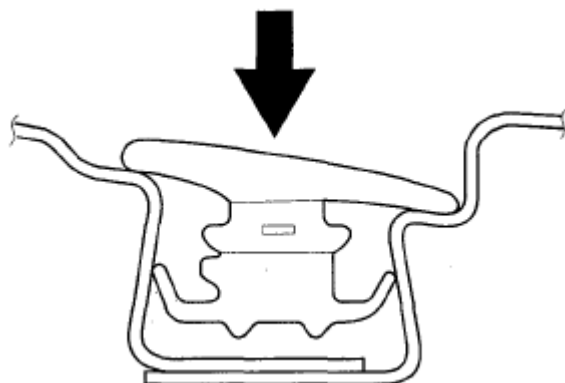

Fig. 17: Installing Roof Molding
Courtesy of AMERICAN HONDA MOTOR CO., INC.

ROOF DRIP MOLDING REPLACEMENT

Special Tools Required

KTC trim tool set SOJATP2014 *

* Available through the American Honda Tool and Equipment Program; call 888-424-6857

NOTE:

- Put on gloves to protect your hands.
- Use the appropriate tool from the KTC trim tool set to avoid damage when prying components.
- Take care not to scratch the trim and panels.
- After removing the roof drip molding, be sure to replace it with a new one.

1. Detach the hooks (A), then remove the rear pillar trim cover (B).

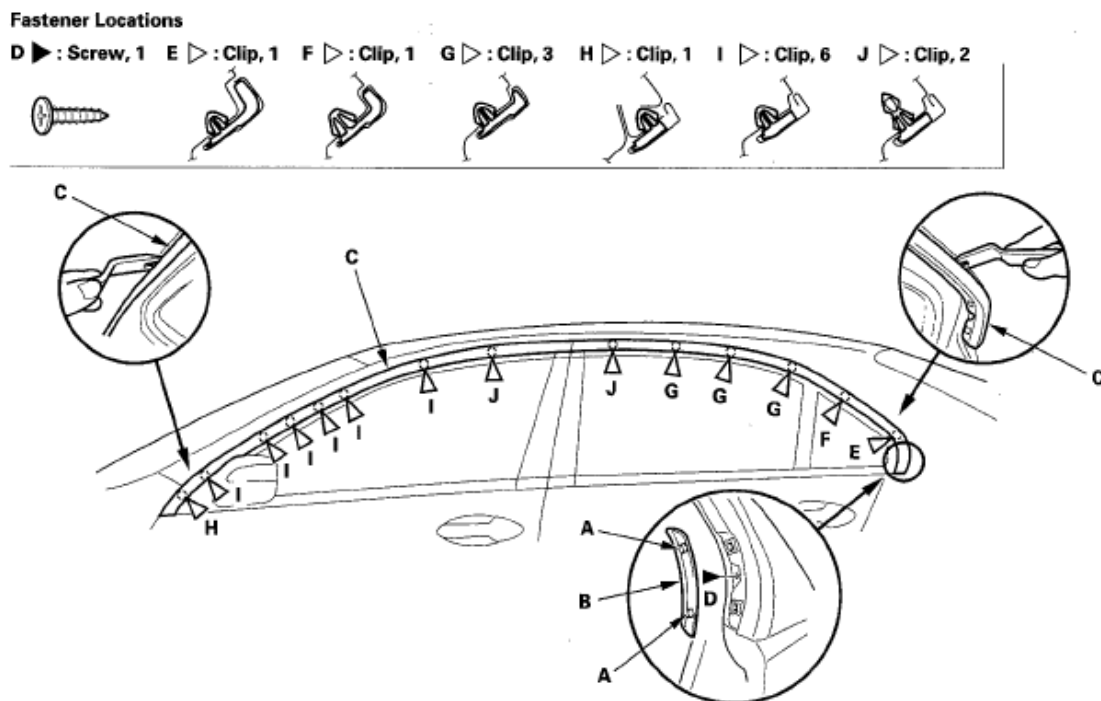

Fig. 18: Identifying Rear Pillar Trim Cover, Roof Drip Molding And Hooks
 Courtesy of AMERICAN HONDA MOTOR CO., INC.

2. Remove the roof drip molding (C).
 1. Remove the screw (D).
 2. Detach the clips (E, F, G, H, I, J) in alphabetical order.
3. Remove the remaining clips from the body, and attach them to the molding.
4. Align the molding with the body, and starting with the middle clips (J), snap the clips into place in reverse alphabetical order.
5. Reinstall the rear pillar trim cover.

DOOR MOLDING REPLACEMENT

Special Tools Required

KTC trim tool set SOJATP2014 *

* Available through the American Honda Tool and Equipment Program; call 888-424-6857

NOTE:

- Use the appropriate tool from the KTC trim tool set to avoid damage when prying components.
- Be careful not to pry too far or you may bend the molding.
- Put on gloves to protect your hands.

1. Remove these items:

- Front door panel (see **FRONT DOOR PANEL REMOVAL/INSTALLATION**) and plastic cover (see step 3 under **FRONT DOOR OUTER HANDLE REPLACEMENT**)
- Rear door panel (see **FRONT DOOR WEATHERSTRIP REPLACEMENT**) and plastic cover (see step 2 under **REAR DOOR GLASS, QUARTER GLASS, AND REGULATOR REPLACEMENT**)

2. Release the clips, and gently pry the front door molding (A) or rear door molding (B) away from the door while separating the adhesive tape (C, D, E).

Adhesive tape (C, D, E): Thickness 1.2 mm (0.047 in.)

Fastener Locations

▷ : Clip, 10

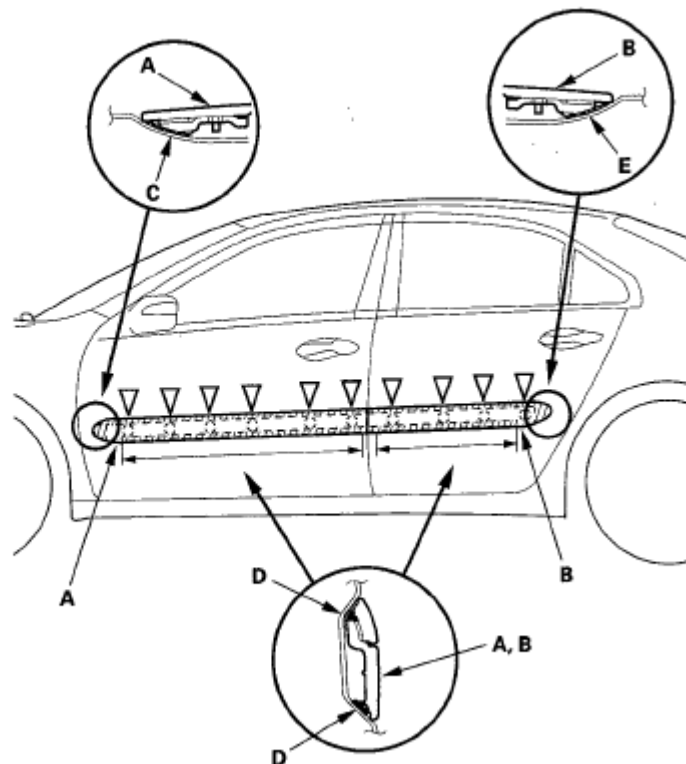
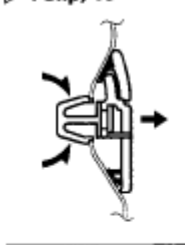

Fig. 19: Identifying Door Molding

Courtesy of AMERICAN HONDA MOTOR CO., INC.

3. Install the moldings in the reverse order of removal.

NOTE: Check if the clips are damaged or stress-whitened, and if necessary, replace them with new ones.

SIDE SILL PANEL REPLACEMENT

Special Tools Required

Push pin puller 07AAC-SJAA100

1. Remove the side sill panel (A).
 1. On the front of the rear wheel arch, remove the screws (B).
 2. Remove the expansion clips (C).
 3. Slide the side sill panel rearward and remove it. The side clips (D) will stay in the body.
 4. Remove the side clips (D) by turning the clip 45° from the body.
 5. On the back of the front wheel arch, remove three screws (E), and on a Canadian model, remove the front splash guard (F).
 6. Turn the side sill inner trim (G) 45° to release the side clip (D), then remove the trim.

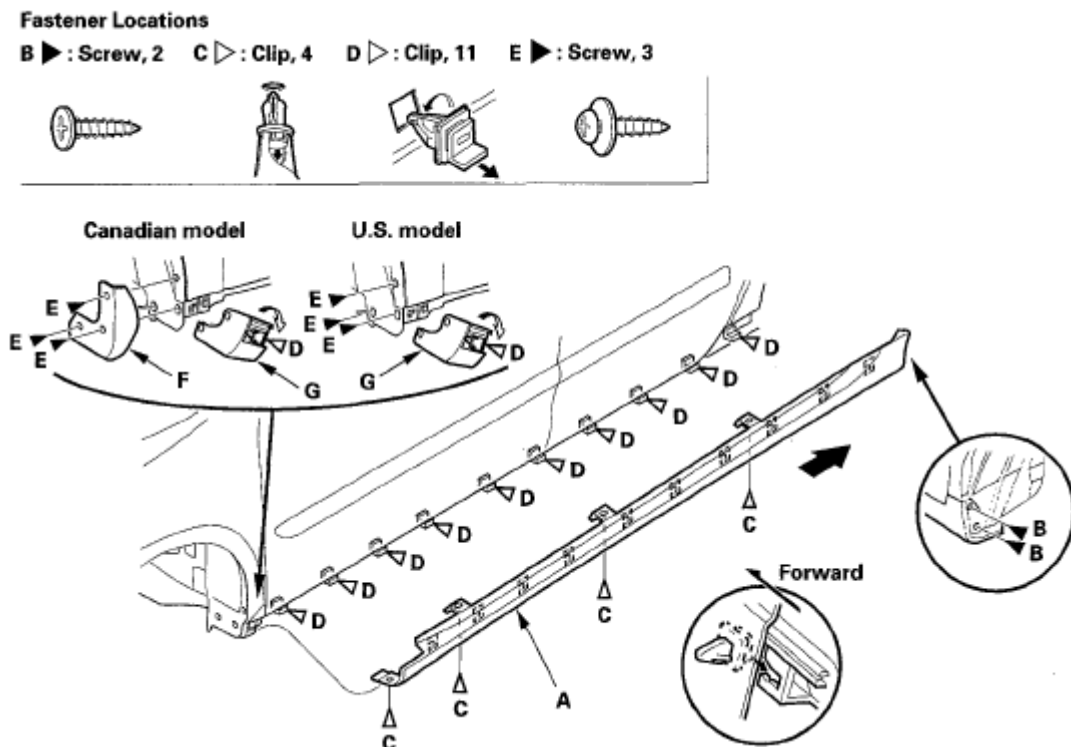

Fig. 20: Identifying Side Sill Panel And Clip
 Courtesy of AMERICAN HONDA MOTOR CO., INC.

2. Check if the clips are damaged or stress-whitened, and if necessary, replace them with new ones.

3. Install the side clips (A) on the side sill panel (B).

Fastener Locations

A ▴ : Clip, 11 D ▴ : Clip, 4 F ▴ : Screw, 3 G ▴ : Screw, 2

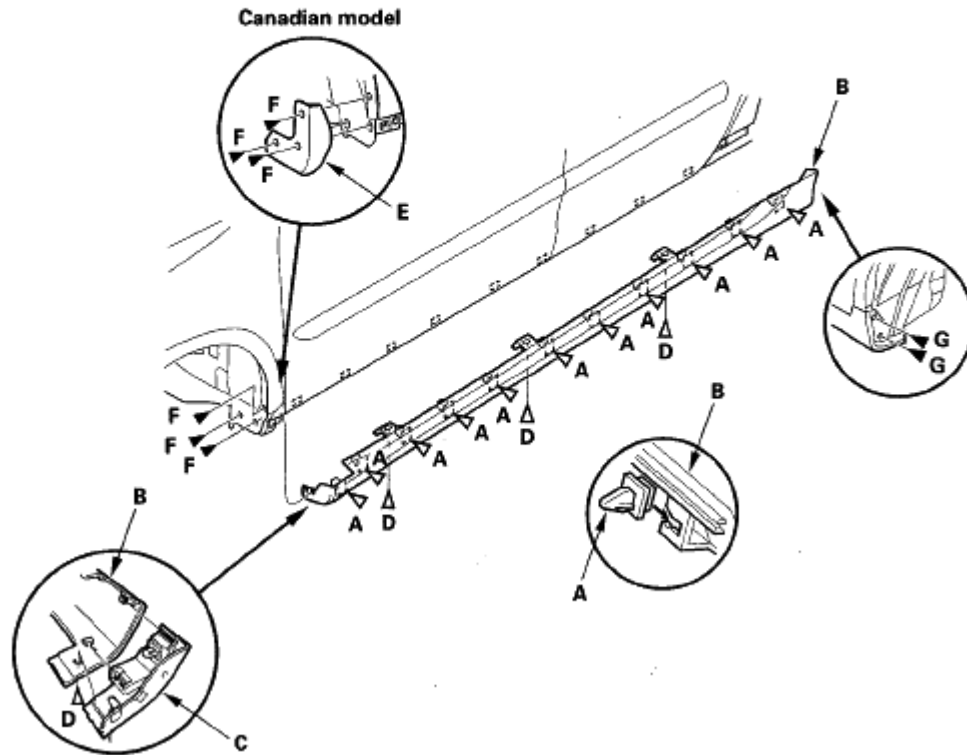

Fig. 21: Identifying Side Sill Panel And Clip

Courtesy of AMERICAN HONDA MOTOR CO., INC.

4. Install the side sill inner trim (C) on the side sill panel, and install the clip (D).
5. Hold the panel up, and fit all the side clips into the holes in the body, then push on the panel until the clips snap into place.
6. Install all the expansion clips (D).
7. Install the front splash guard (E) (Canadian model), and the screws (F, G).

SIDE SILL PROTECTION TAPE REPLACEMENT

1. Slowly peel off the old side sill protection tape.
2. Clean the side sill panel bonding surface with a sponge dampened in alcohol. After cleaning, keep oil, grease, and water from getting on the surface.
3. Peel the adhesive backing from the side sill protection tape.
4. Align the side sill protection tape (A) with the edge of the side sill panel (B), then press it into place.

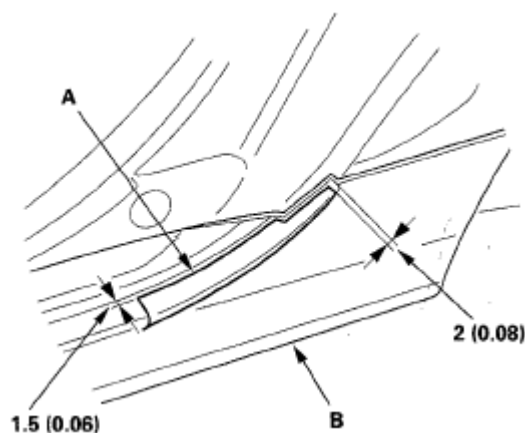

Fig. 22: Identifying Side Sill Protection Tape
Courtesy of AMERICAN HONDA MOTOR CO., INC.

REAR LICENSE TRIM REPLACEMENT

NOTE: Put on gloves to protect your hands.

1. Remove the trunk lid trim (see **TRIM REMOVAL/INSTALLATION - TRUNK LID**).
2. Remove the screws from the rear license trim (A).

Fastener Locations

► : Screw, 2

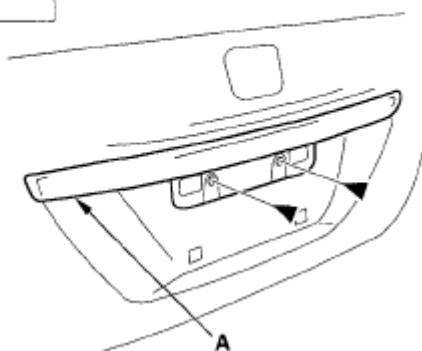
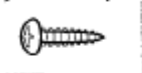
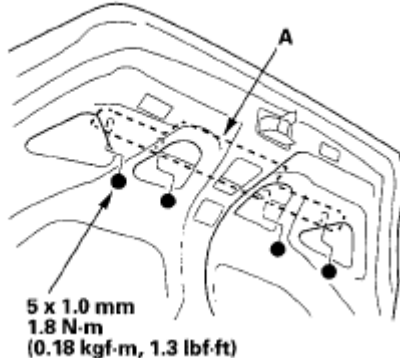

Fig. 23: Identifying Rear License Trim And Screws
Courtesy of AMERICAN HONDA MOTOR CO., INC.

3. From inside the trunk lid, remove the nuts securing the rear license trim (A).

Fastener Locations

● : Nut, 4



5 x 1.0 mm
1.8 N·m
(0.18 kgf·m, 1.3 lbf·ft)

Fig. 24: Identifying Rear License Trim With Torque Specifications
Courtesy of AMERICAN HONDA MOTOR CO., INC.

4. Gently close the trunk lid, and pull the rear license trim (A) out to detach the clip, then remove the trim. Take care not to scratch the trunk lid.

Fastener Location

▷ : Clip, 1

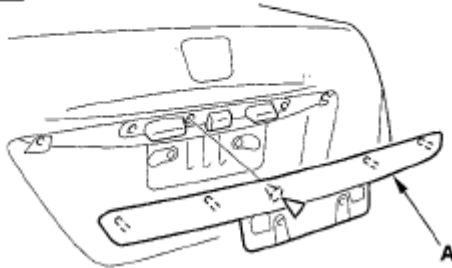

Fig. 25: Pulling Rear License Trim
Courtesy of AMERICAN HONDA MOTOR CO., INC.

5. Install the trim in the reverse order of removal, and note these items:
 - Check if the clip is damaged or stress-whitened, and if necessary, replace it with a new one.
 - Push the clip into place securely.

TAILLIGHT TRIM REPLACEMENT

Special Tools Required

KTC trim tool set SOJATP2014 *

* Available through the American Honda Tool and Equipment Program; call 888-424-6857

NOTE:

- Use the appropriate tool from the KTC trim tool set to avoid damage when prying components.
- Take care not to scratch the body.

1. Detach the clips and the hooks (A), then remove the taillight trim (B).

Fastener Locations

▷ : Clip, 2

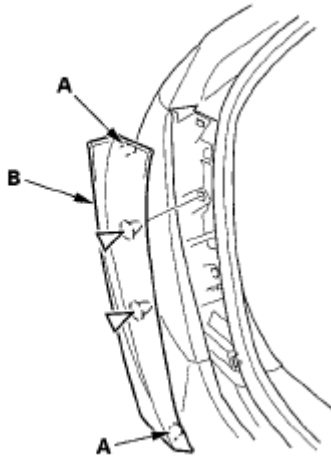

Fig. 26: Identifying Taillight Trim, Clips And Hooks
Courtesy of AMERICAN HONDA MOTOR CO., INC.

2. Install the trim in the reverse order of removal, and note these items:
 - Check if the clips are damaged or stress-whitened, and if necessary, replace them with new ones.
 - Push the clips and hooks into place securely.

TRUNK OPENING PANEL REPLACEMENT

Special Tools Required

KTC trim tool set SOJATP2014 *

* Available through the American Honda Tool and Equipment Program; call 888-424-6857

NOTE:

- Use the appropriate tool from the KTC trim tool set to avoid damage when prying components.
- Take care not to scratch the body.

1. Remove the taillight trim.
2. Separate the double-sided adhesive tape (A), and use a trim tool to detach the pins (B) of the trunk opening panel (C).

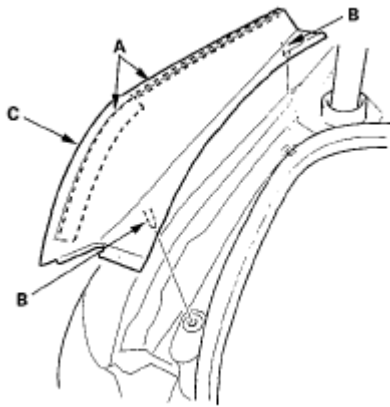

Fig. 27: Identifying Double-Sided Adhesive Tape, Pins And Trunk Opening Panel
Courtesy of AMERICAN HONDA MOTOR CO., INC.

3. Install the trunk opening panel in the reverse order of removal, and note these items:
 - Scrape off the remaining double-sided adhesive tape from the cover and body, then clean the cover and body surface with a sponge dampened in alcohol.
 - Apply new adhesive tape (A) to the trunk opening panel (B).
 - Push the adhesive portions and pins into place securely.

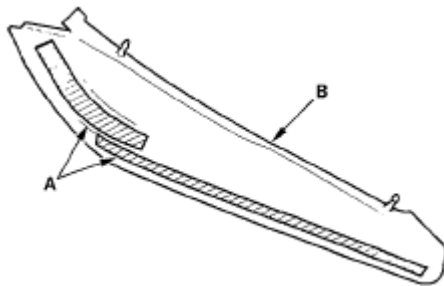

Fig. 28: Identifying Trunk Opening Panel And Adhesive Tape
Courtesy of AMERICAN HONDA MOTOR CO., INC.

EMBLEM/STICKER REPLACEMENT

NOTE: When removing the emblems/stickers, take care not to scratch the body.

1. Clean the body surface with a sponge dampened in alcohol. After cleaning, keep oil, grease, and water from getting on the surface.
2. Apply the emblem/sticker where shown. When installing the ULEV sticker on the inside surface of the left rear door quarter glass, align the sticker with the edge of the glass mark and black ceramic as shown, then press the sticker into place, and remove the application tape.

2007 Acura RL

2005-08 ACCESSORIES AND EQUIPMENT Exterior Trim - RL

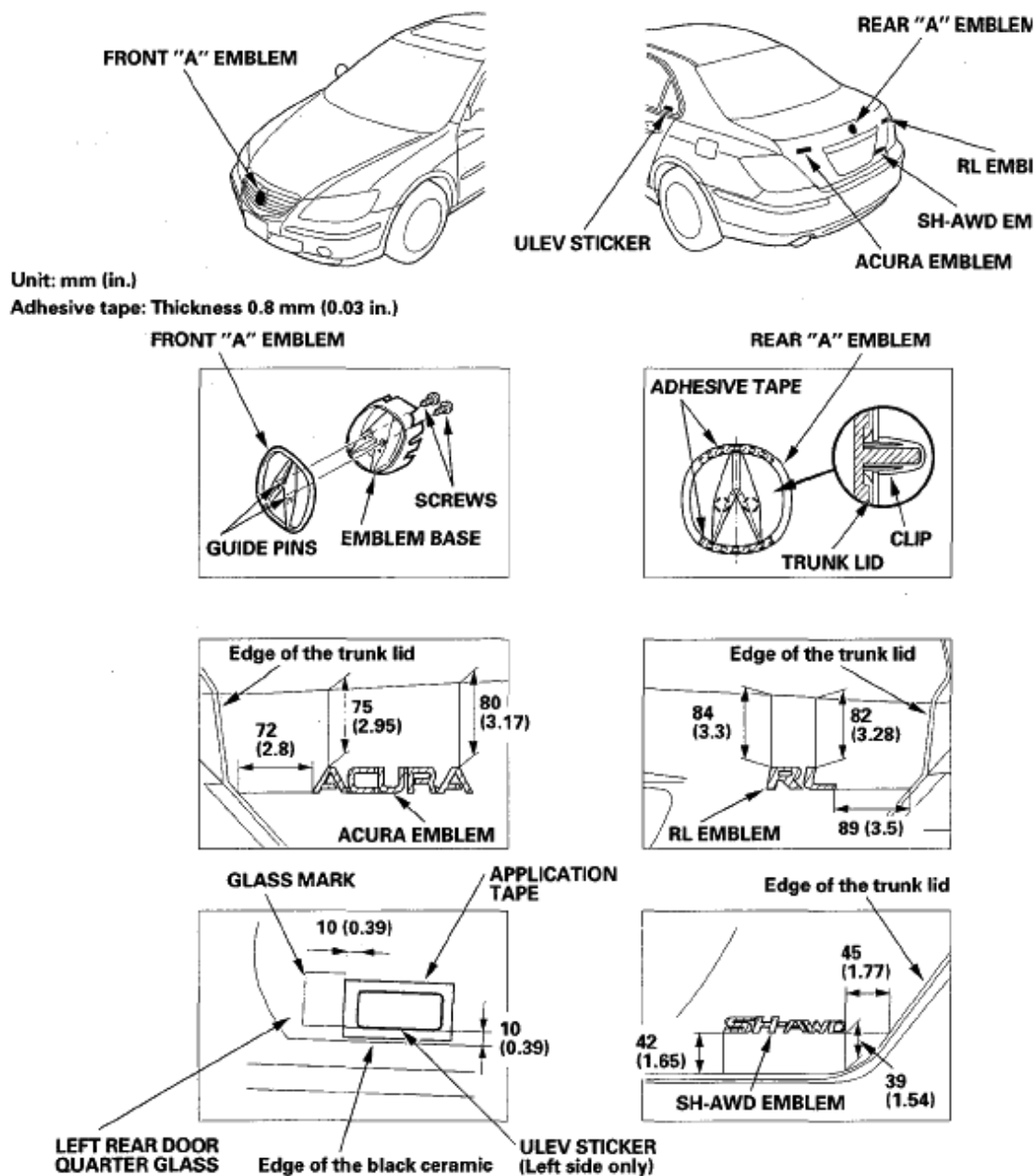

Fig. 29: Views Of Emblem And Sticker Replacement
Courtesy of AMERICAN HONDA MOTOR CO., INC.